

NOTICE OF TAX ABATEMENT CONSIDERATION

PARMER COUNTY COMMISSIONERS COURT

DATE: October 15, 2024

TIME: 10:00 A.M.

PLACE: Parmer County Courthouse, 401 3rd Street, Farwell, Texas

PURPOSE: The Parmer County Commissioners Court will discuss and take possible action regarding an Amended and Restated Tax Abatement Agreement with Lazbuddie Wind Energy II LLC, pursuant to Chapter 312 of the Texas Tax Code.

Property Owner and Applicant (“Applicant”) for Tax Abatement: Lazbuddie Wind Energy II LLC

Reinvestment Zone: Parmer-Lazbuddie Wind Reinvestment Zone #2

Property in Reinvestment Zone: See attached map and description provided in Exhibit “A” attached hereto and incorporated herein for all purposes.

Anticipated Improvements: The general description of the nature of the improvements included in the agreement is as follows:

Applicant anticipates constructing a wind power electric generation facility with a Nameplate Capacity of at least two hundred thirty-five (235) megawatts of nameplate capacity. Improvements may include (but are not limited to) wind turbines, towers, foundations, roadways, buildings and offices, meteorological equipment (anemometer towers and SODAR), computer equipment; furniture, company vehicles, electrical transmission cables and towers, and electrical substations, and associated equipment for generating, storing, controlling, and transmitting electricity.

Summary of Proposed Amendments:

The Amended and Restated Tax Abatement Agreement would reference the new Parmer-Lazbuddie Wind Reinvestment Zone #2 as well as extend the Commercial Operations date so that the Owner agrees that the Project shall achieve Commercial Operations on or before December 31, 2028.

Estimated Cost of the Improvements: The estimated cost of the improvements being contemplated by Applicant is approximately \$300,000,000.00.

**FOR DETAILED INFORMATION OR QUESTIONS CALL THE COUNTY JUDGE’S OFFICE
AT (806) 481-3383**

CERTIFICATION

I certify that the above Notice of Tax Abatement Amendment Consideration was posted on the County's website and on the bulletin board at the Courthouse door of Parmer County, Texas, at a place readily accessible to the general public at all times on the 12th day of September, 2024, and pursuant to Texas Tax Code 312.207 and Chapter 551, Texas Government Code, said Notice remained so posted continuously for at least 30 days preceding the scheduled time of said Meeting.

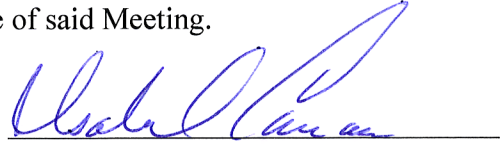

Izzy Carrasco
County Judge, Parmer County, Texas

FILED 12th DAY OF Sep
2024 AT 11:45 A.M.
COUNTY CLERK
PARMER COUNTY, TEXAS
BY Mayra Chacon
COUNTY CLERK DEPUTY

EXHIBIT A
DESCRIPTION AND MAP OF
PARMER-LAZBUDDIE WIND REINVESTMENT ZONE #2

The Parmer-Lazbuddie Wind Reinvestment Zone #2 is comprised of the following parcels located in Parmer County, Texas. In the event of discrepancy between the following description and the attached map, the map will control; provided however, the Parmer-Lazbuddie Wind Reinvestment Zone #2 shall in no way be deemed to include any portion of any municipality.

<u>Property Owner</u>	<u>Parcel ID #</u>	<u>Acreage</u>
H H HORTON	3938	159.21
H H HORTON	3940	78.92
H H HORTON	3942	79.67
MIKE BEAUCHAMP	3968	160.27
H H HORTON	3969	317.53
H H HORTON	3970	64.10
DOROTHY SORLEY	3975	312.87
DOROTHY SORLEY	3985	158.51
RAIDER FARMS INC	3987	155.61
MIKE BEAUCHAMP	4114	116.71
MIKE BEAUCHAMP	4116	312.33
MIKE BEAUCHAMP	4118	156.50
MIKE BEAUCHAMP	4119	157.20
MIKE BEAUCHAMP	4120	155.48
FRIONA LAND HOLDINGS LLC	4132	34.79
MONROE CLARENCE FLP	4785	119.14
MONROE CLARENCE FLP	4786	40.60
ALAN MONROE	4787	146.22
MONROE PARTNERSHIP FARMS	4800	310.04
A TEX DAIRY LLC	5544	157.35
A TEX DAIRY LLC	5545	471.68
A TEX DAIRY LLC	5546	316.93
BOBBY DANIEL	5551	621.06
DANIEL BOBBY	5551	9.48
KENMAR FARMS LLC	5554	315.07
MONROE CLARENCE FLP	5563	236.31
MONROE PARTNERSHIP FARMS	5565	312.08
FLOYD S REEVE	5577	232.37
MONROE PARTNERSHIP FARMS	5578	224.15
B & Z THORN INC	5579	230.59

MIKE BEAUCHAMP	5612	156.82
LOJO CORP	5613	469.25
RAIDER FARMS INC	5614	156.18
FLOYD S REEVE	5618	156.27
MIKE BEAUCHAMP	5624	319.74
MARK GAMMON	5666	144.46
B & Z THORN INC	5674	314.33
SARAH BLACK	5686	154.45
SARAH BLACK	5695	159.31
HUNTON FAMILY TRUST	5696	472.62
B & Z THORN INC	5697	474.57
GLENN LUST	6349	326.90
MIKE BEAUCHAMP	6653	315.13
GARRY BEAUCHAMP	6654	154.83
MIKE BEAUCHAMP	6655	626.17
ANTHONY BEAUCHAMP	6676	314.85
MIKE BEAUCHAMP	12797	156.33
GARRY BEAUCHAMP	13179	159.41
ANTHONY BEAUCHAMP	19249	138.14
MONROE FARMS PARTNERSHIP; B. ARNETT	205469	313.17
MARK GAMMON	221308	157.59
POSTHUMUS ALBERT	5526	50.00
WARREN BONNIE	11360	320.00
TRANSWESTERN PIPELINE CO	1791	4.21
PROCORO RODRIGUEZ	2826	0.14
JOSEPH VASEK DONALD	3904	633.75
BILL WHITE	3905	238.76
BILL WHITE	3906	157.32
BILL WHITE	3907	156.21
BILL WHITE	3908	78.77
MCCLARAN LAND & CATTLE CO.	3910	121.85
BILL K WHITE	3912	317.12
SD FARMS	3913	157.13
CRAIG RICHARD HUNT	3914	159.82
SUE MCCLARAN	3915	162.78
METROPOLITAN RADIO GROUP	3916	0.60
HEATH PARTNERSHIP	3917	157.17
LANCE & TRISHA MCCLARAN	3919	89.36
HOUSTON BARTLETT	3920	79.20
HOUSTON BARTLETT	3922	147.58
MCCAIN LAND & CATTLE CO. LTD	3928	235.00

SD FARMS	3930	98.65
MCCAIN LAND & CATTLE CO. LTD	3931	78.45
S D Farms	3933	156.78
SUE MCCLARAN	3934	156.46
SD FARMS	3935	156.44
STEVEN LYNN STAFFORD	3936	313.07
AK CORAL CAY TRUST	3937	551.55
PRINTES PRUITT	3941	78.06
SD FARMS	3944	243.90
JARECKI PARTNERSHIP LLP	3945	390.54
AK CORAL CAY TRUST	3946	311.93
EJ DEGROOT	3947	314.27
CARROL COOK	3949	36.01
KRIEGEL INC	3952	146.99
LARRY EUGENE EZELL	3954	157.42
ESTHER STEELMAN	3958	325.04
CYNTHIA COTTON	3959	157.34
CARROL COOK	3960	400.28
ESTHER STEELMAN	3962	79.44
SBM HOLDINGS PARTNERSHIP	3963	155.91
SBM HOLDINGS PARTNERSHIP	3964	157.37
ABCD FLEMING	3965	157.63
CYNTHIA COTTON	3966	157.77
SD FARMS	3967	159.67
SD FARMS	3971	157.26
ABCD FLEMING	3972	421.93
ABCD FLEMING	3973	640.70
ESTHER STEELMAN	3974	316.87
WES COCKERHAM	3976	316.69
JIMMIE L COCKERHAM	3977	76.69
JIMMIE L COCKERHAM	3978	239.48
COTTON RIVER CATTLE CO.	3979	155.94
BARRETT	3983	155.31
ROCKING C FARMS INC	3989	235.09
CHRISTIAN, CHARLES	3990	394.65
KEN SORLEY	4059	311.06
HETTINGA HEIN & ELLEN HETTINGA (TE)	4065	313.07
FRIONA LAND HOLDINGS LLC	4115	156.84
GRADY SORLEY	4121	311.46
HETTINGA	4122	311.60
HETTINGA HEIN & ELLEN HETTINGA (TE)	4123	313.46

HETTINGA HEIN & ELLEN HETTINGA (TE)	4126	257.86
BARBARA MCGUIRE EVANS	4127	156.65
CIRCLE C FARMS	4128	108.58
TODD SCHILLING	4129	109.48
KEN SORLEY	4131	110.23
LEON SCHILLING	4133	313.08
LAURA BARTLETT MCPHAUL	4146	2.01
CRAIG SHIELDS	4778	313.90
NICHOLS INVESTING CO	4779	187.93
JODY LEWELLEN	4780	10.00
DAVID M KATHLEEN CARTHEL	4781	157.73
DAVID M KATHLEEN CARTHEL	4782	157.64
CONLEY FAMILY LIVING TRUST	4783	317.98
J DEE WILLARD	4784	2.97
PHILLIP TAWANNA ZELLER	4788	10.38
PHILLIP TAWANNA ZELLER	4789	3.03
CONLEY FAMILY LIVING TRUST	4790	309.59
DAVID CARTHEL	4791	309.71
LINDA CHESHER	4793	156.64
FRIONA WHEAT GROWERS	4801	2.67
T B MASON	4802	3.58
T B MASON	4802	310.21
TRUELL HYDE	4803	155.67
MICHAEL RUSHING	4806	630.30
MICHAEL RUSHING	4807	485.16
MICHAEL RUSHING	4808	376.07
MICHAEL RUSHING	4809	486.53
SHARON R WHITE	5323	158.68
BETTY L MCINROE	5325	159.53
DAVID HOUGH	5326	159.25
WELLS PARTNERSHIP	5327	157.44
WELLS PARTNERSHIP	5328	157.26
RICKEY RECTOR	5330	1.48
FISCHBACHER JIM D & TRACY D	5331	153.81
FISCHBACHER JIM D & TRACY D	5332	156.27
DAVID HOUGH	5333	314.41
MILDRED MINGUS	5334	471.46
SHARON R WHITE	5335	232.09
RAFTER W PARTNERSHIP	5336	1.16
RAFTER W PARTNERSHIP	5336	1.16
RAFTER W PARTNERSHIP	5336	156.58

RAFTER W PARTNERSHIP	5337	157.94
YOUNG FAMILY FARM LLC	5342	160.38
YOUNG FAMILY FARM LLC	5343	159.09
BILL WHITE	5344	311.43
FISCHBACHER JIM D & TRACY D	5345	313.03
JARECKI PARTNERSHIP LLP	5346	312.58
FLOYD S REEVE	5418	273.44
HAND DANNY & JISELLE	5419	155.75
DUSTIN THOMPSON	5420	195.96
WELCH FAMILY TRUST	5422	309.94
LORETTA KAYE HAND	5423	196.10
DUSTIN THOMPSON	5425	315.00
OPTIMA DAIRY TEXAS LLC	5426	314.87
DAVID & RENE HOUGH	5446	317.92
CRIS INGRAM	5455	153.73
ROBERT SAIZ	5456	4.41
CRIS INGRAM	5457	155.41
FISCHBACHER JIM D & TRACY D	5461	156.76
CRIS INGRAM	5462	157.70
LINDA CHESHER	5463	128.17
DAVID & RENE HOUGH	5465	156.95
KENMAR FARMS LLC	5466	313.27
EUGENE BANDY	5470	315.08
OPTIMA DAIRY TEXAS LLC	5473	317.47
OPTIMA DAIRY	5474	309.64
DUSTIN THOMPSON	5475	160.24
ERIC RUSHING	5476	235.92
WESSLIE HAND	5478	208.45
DAVID WARREN HOUGH	5479	165.69
DUSTIN THOMPSON	5480	312.24
KENMAR FARMS LLC	5481	315.48
PATRICIA KAY ROGERS	5482	156.53
CRIS INGRAM	5483	306.16
CRIS INGRAM	5484	7.50

EXHIBIT A (CONTINUED)

MAP OF PARMER-LAZBUDDIE WIND REINVESTMENT ZONE #2

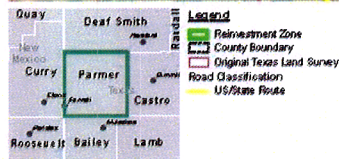
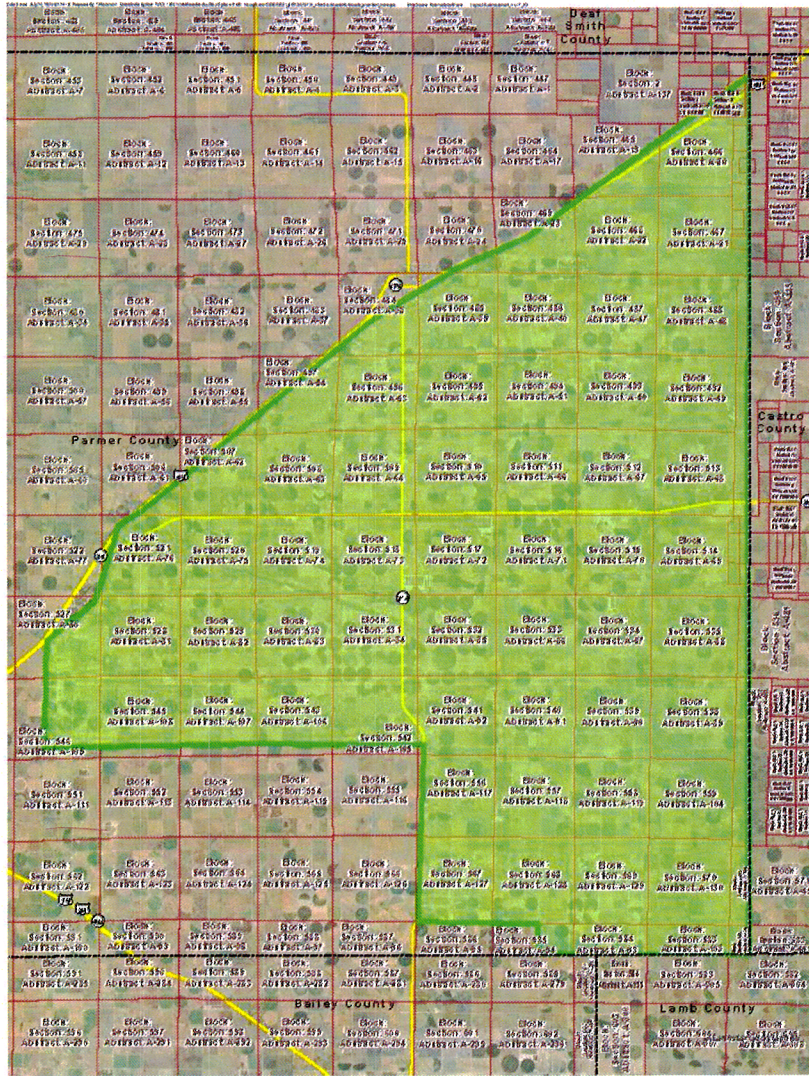

Reinvestment Zone
Lazbuddie Wind Energy Center | Parmer County, Texas

July 24, 2024

Invenergy